

A Priori Modelling of Fire Test One

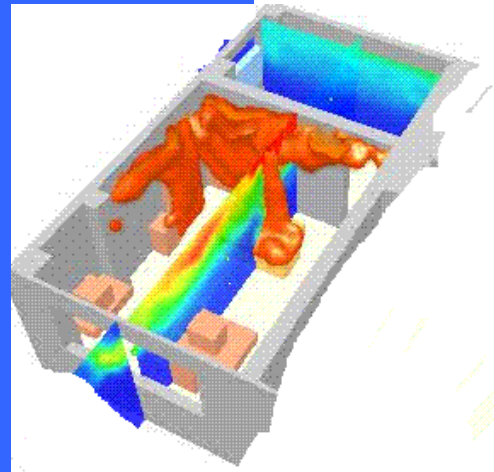

One Day Symposium on
**The Dalmarnock Fire Tests:
Experiments & Modelling**

Wednesday 14th November 2007
Royal Museum, Edinburgh
www.see.ed.ac.uk/FIRESEAT



Authorship: Brave Users

Guillermo Rein, José L. Torero, Wolfram Jahn, Jamie Stern-Gottfried,
Noah L. Ryder, Sylvain Desanghere, Mariano Lázaro, Frederick
Mowrer, Andrew Coles, Daniel Joyeux, Daniel Alvear,
Jorge A. Capote, Allan Jowsey and Pedro Reszka



ARUP



University of Edinburgh, UK
ArupFire London, UK
ArupFire San Francisco, USA
Universidad de Cantabria, Spain
CTICM and Efectis, France
Packer Engineering, USA
University of Maryland, USA

The Art of Fire Modelling

- Fire Modelling is very commonly used now
 - **Where:** Risk, Live safety, Performance based Design, Structural behaviour, Forensic investigations...
 - **What:** Ignition, Flame, Plume, Smoke, Spread, Visibility, Toxicity, Extinction...
-
- Many papers addressing *validation* of fire models
 - but what about *fire modelling*?
 - Do we really know the Strengths and Limitations of the whole process?

The need for Round-Robin Studies

- International pool of experts independently provide *a priori* predictions of a large-scale test (Test One) using a common set of input data.
- **Assessing of the state-of-the-art of fire modelling**
- Very few *a priori* predictions/round-robins have been published
- What is the real use for Fire Engineering of validations conducted *a posteriori*?



Flat Layout

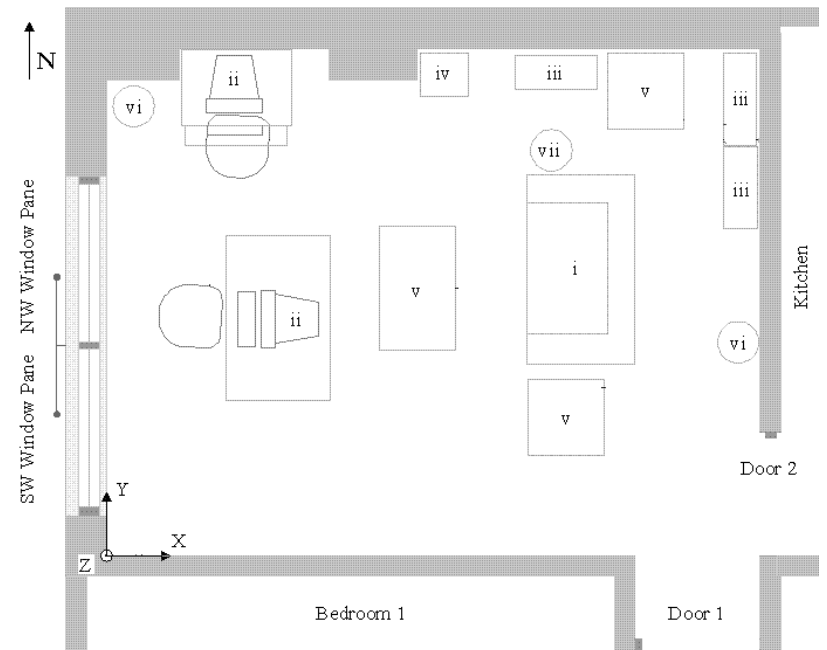
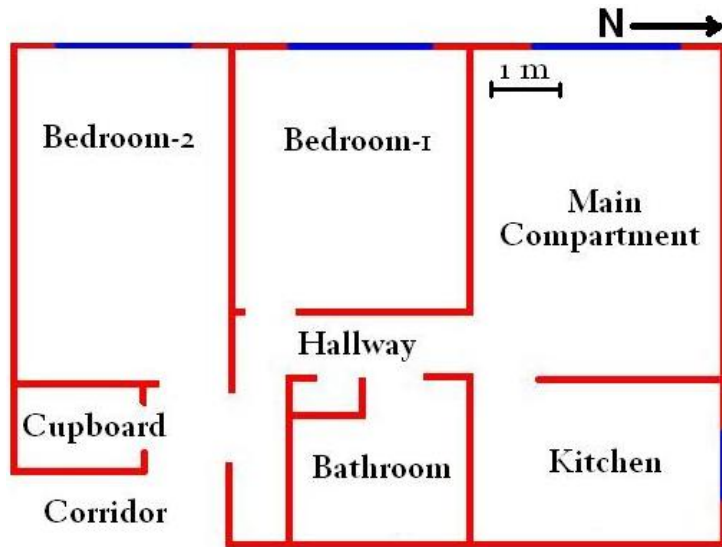

Average Temperature

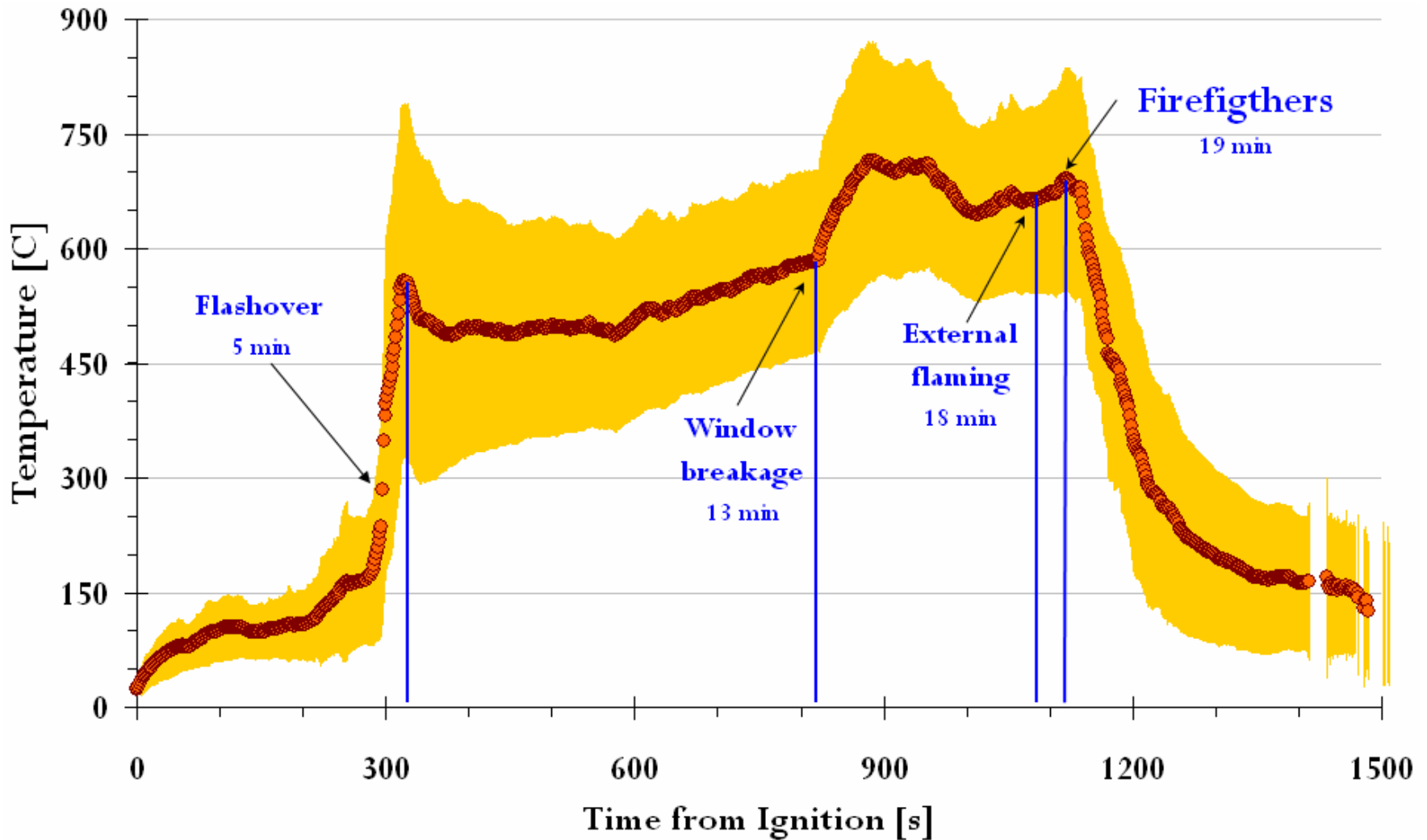

Information Provided to Teams

- Detailed geometry (plan and dimensions)
- Detailed fuel load (dimensions, locations, photographs, descriptions)
- Ventilation conditions
- 50+ Photographs of final set up in the compartment
- HRR of Ignition source and Sofa as measured in the laboratory
- Assumptions, uncertainties, unknown values, missing information were to be complemented by the team's own decisions: as in any other fire modelling work



Unity and Diversity

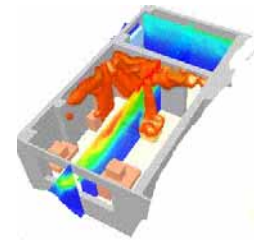

- Predictions in for zones and for fields
- 10 Submitted simulations: 8 Field Models (FDS v4) and 2 Zone models (CFAST v6)

(unfortunately users of other codes declined our invitation)

- Out of the 10 simulations, the input file used

Input of HRR:

- 2 *fully-prescribed* the HRR
- 7 *partially prescribed* the HRR
- 1 *fully predicted* the HRR

Input of Ignition source:

- 5 *did not* use the Sofa curve measured
- 3 used the Sofa curve measured but *extrapolated*
- 1 used the Sofa curve *as measured*

Possible Outcomes: *a priori* discussions

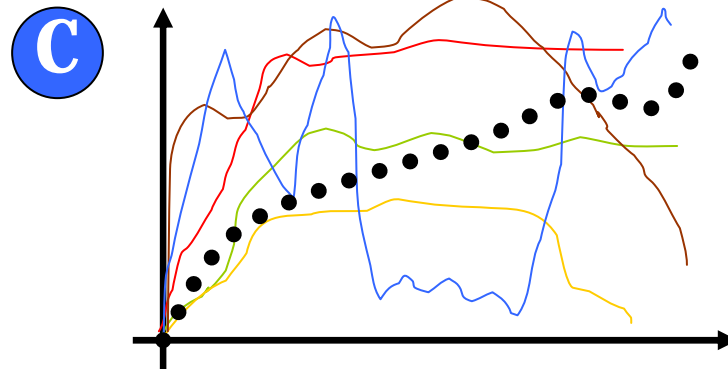
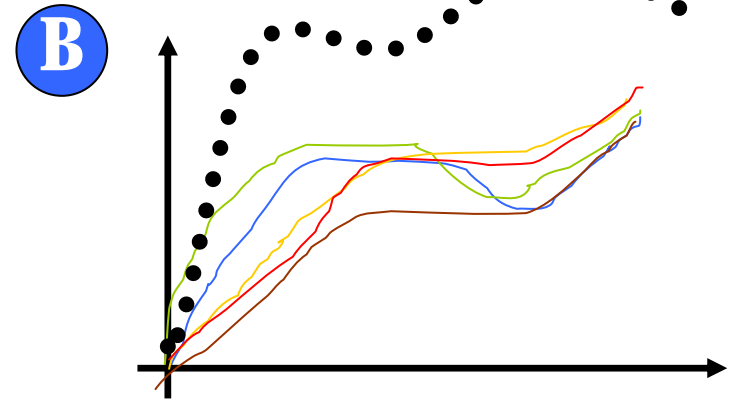
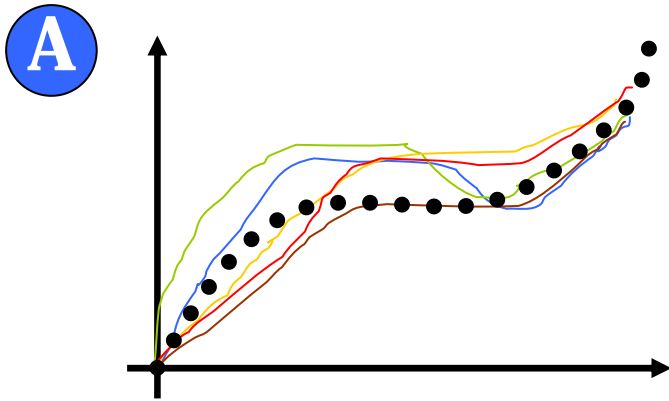

Variables shown here:
HRR, Smoke layer,
Wall temperature
and heat fluxes

**"I always avoid prophesying
beforehand**

**because it is much better to
prophesy after the event has
already taken place"**

Sir Winston Churchill, circa 1945

Results: HRR

Heat Release Rate of the Fire (G-files)

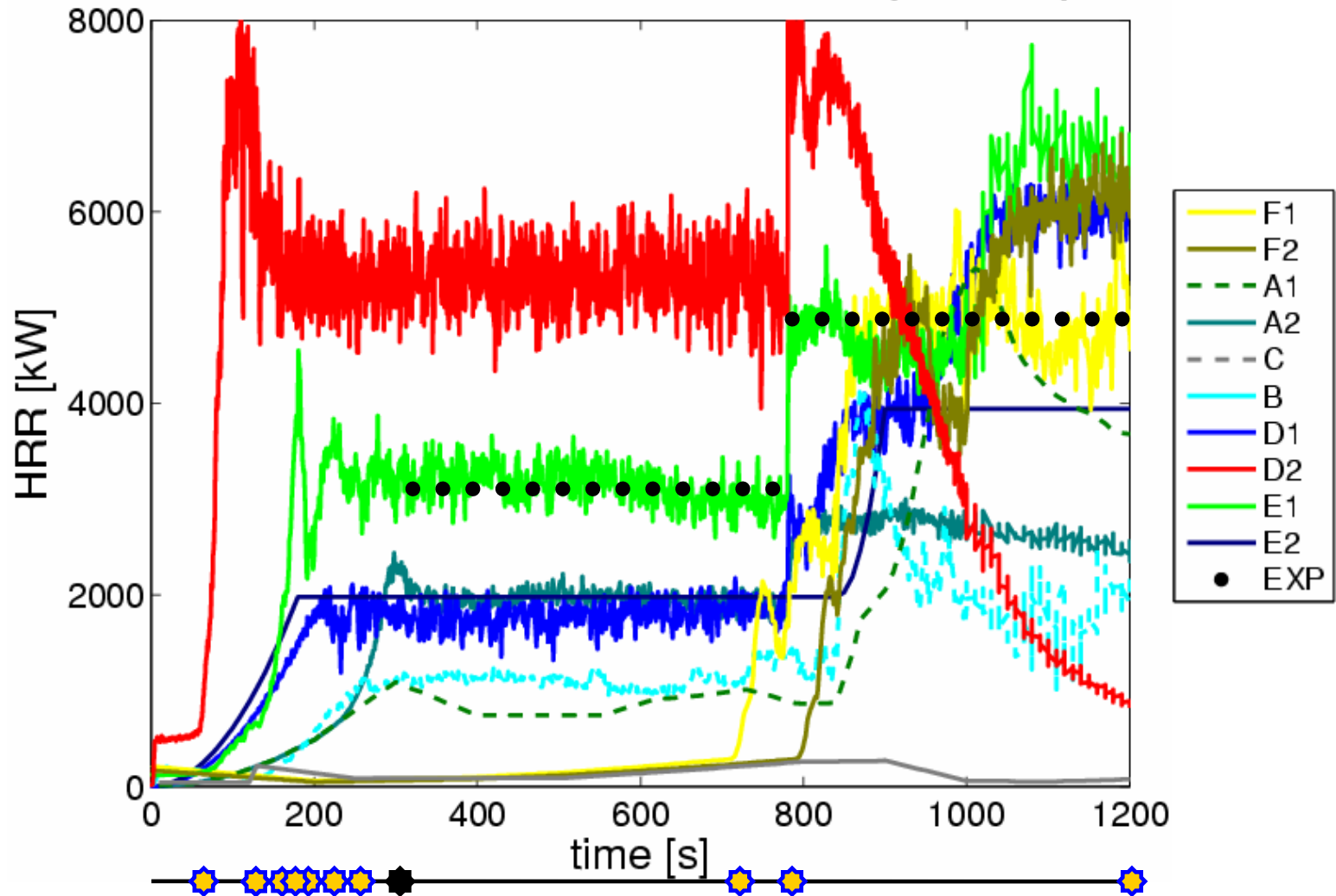

Results: HRR

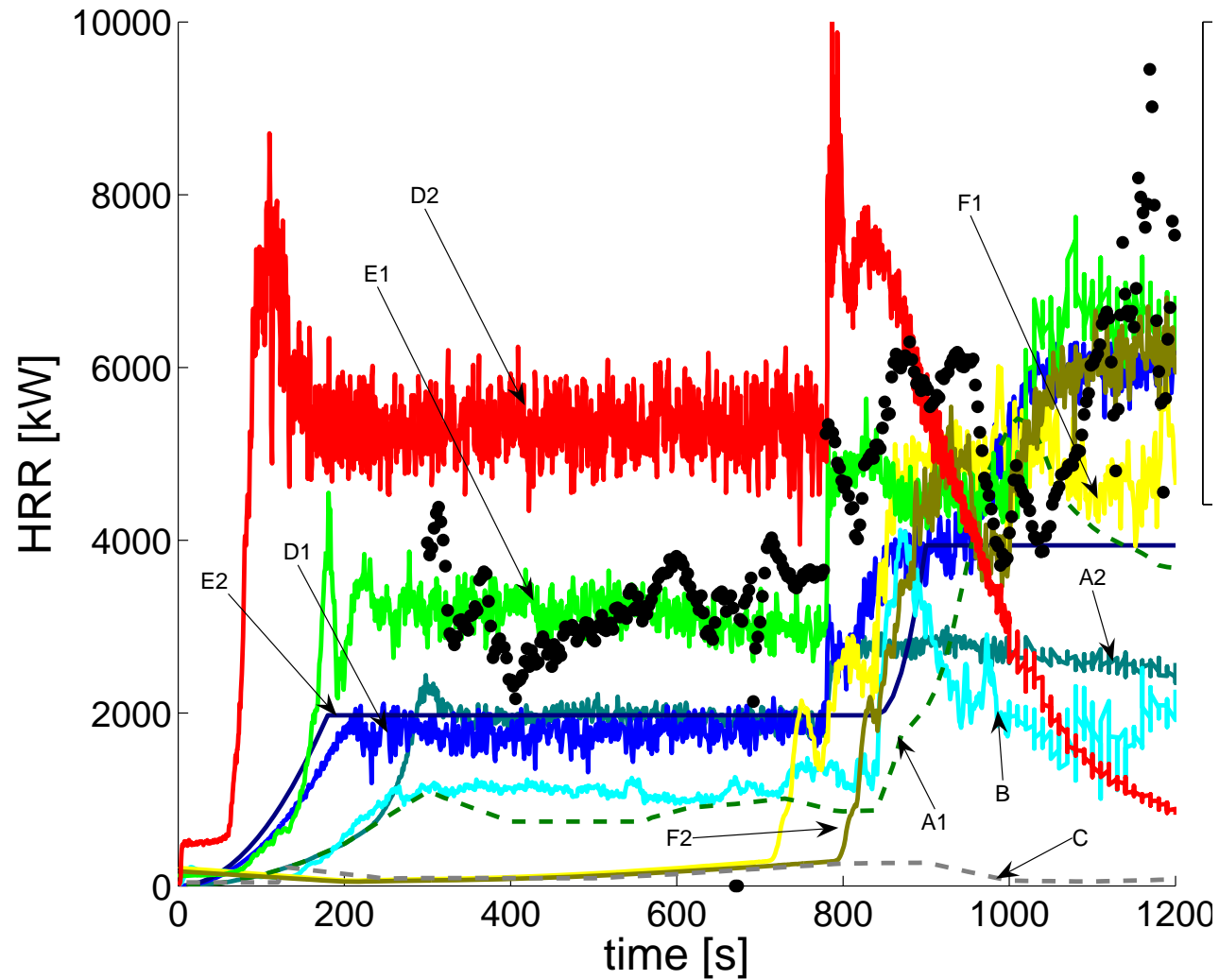

Results: Hot Layer Temperature

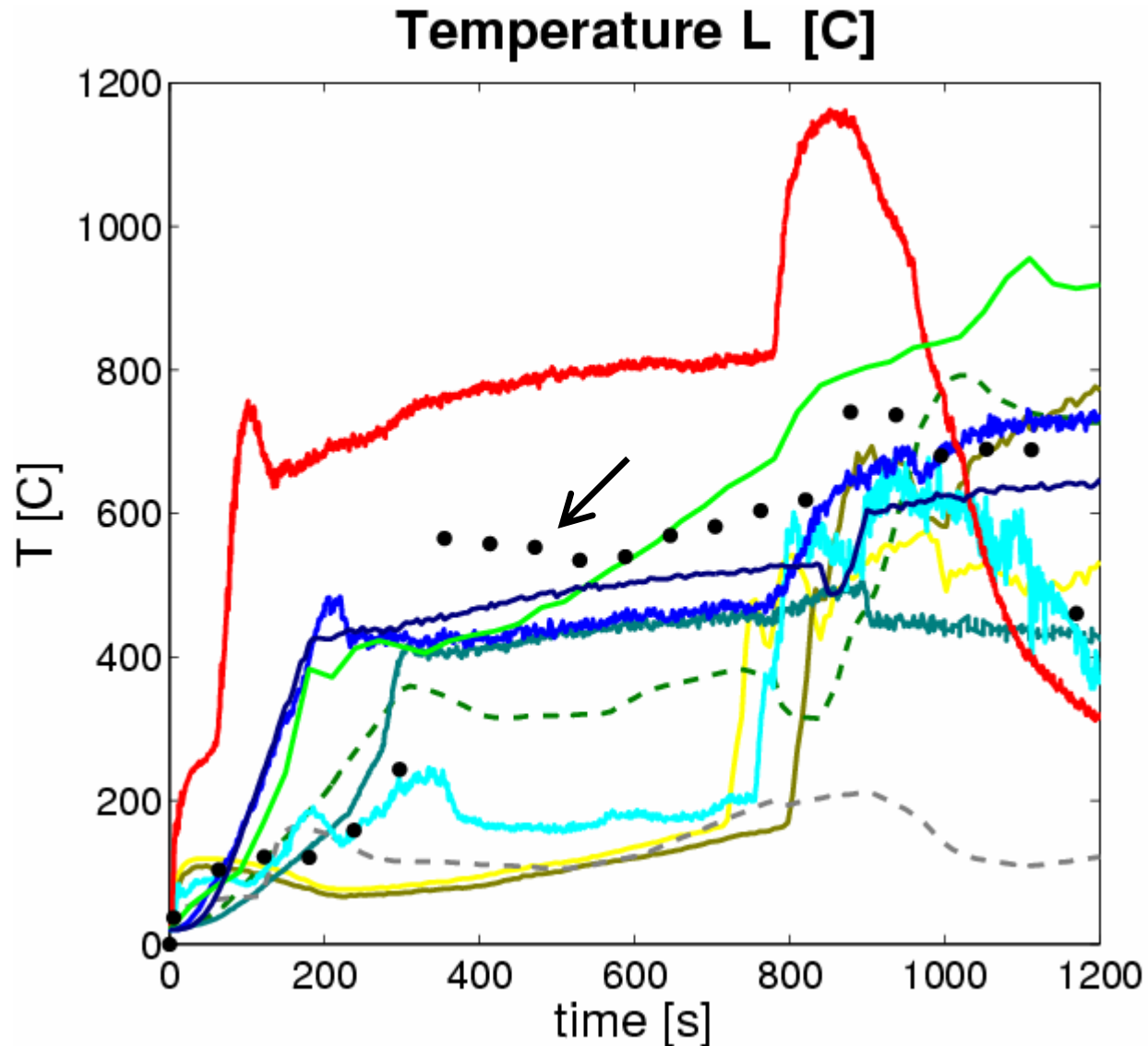

Results: Hot Layer Height

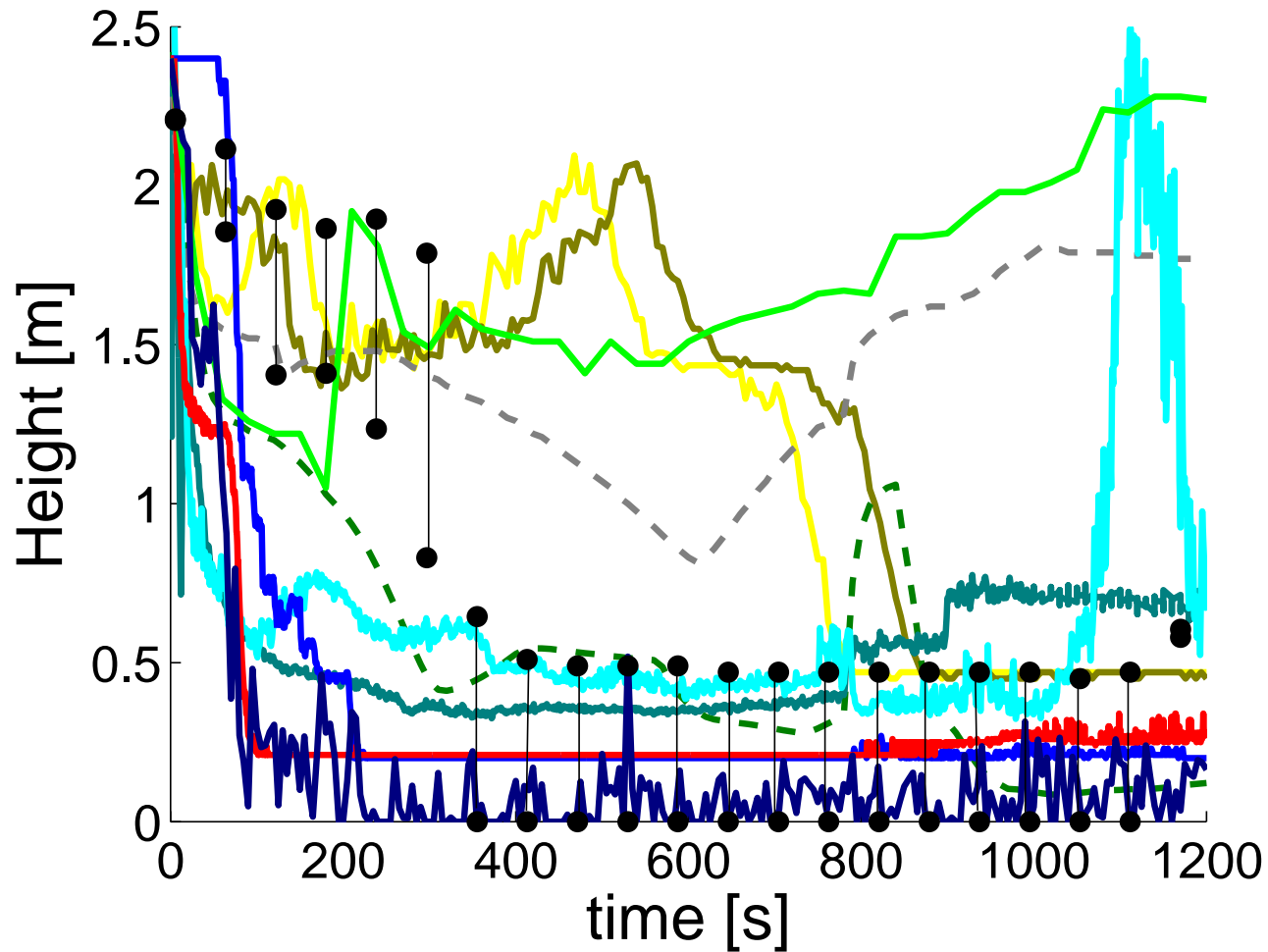

Results: Field Temperature

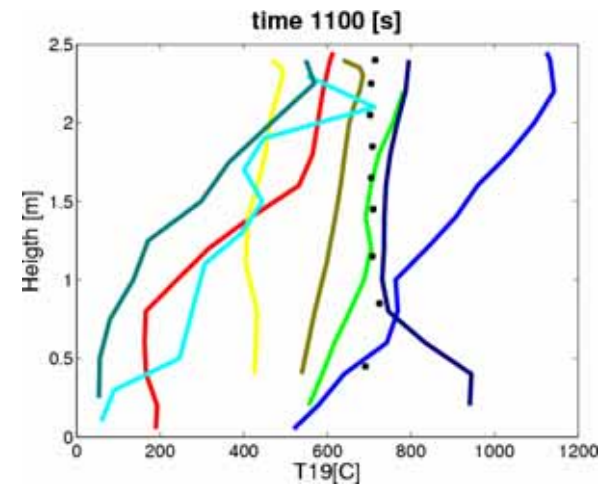
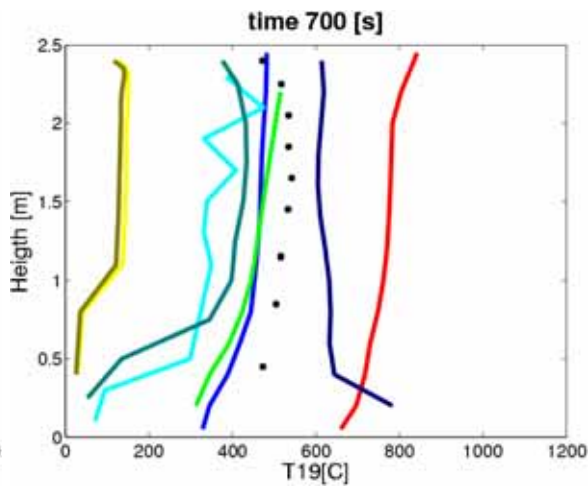
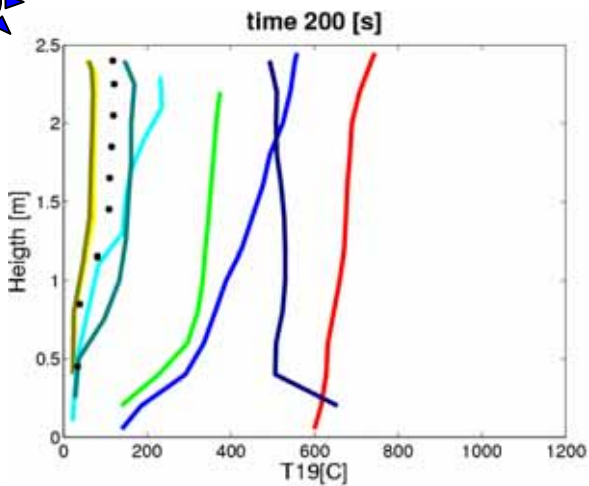
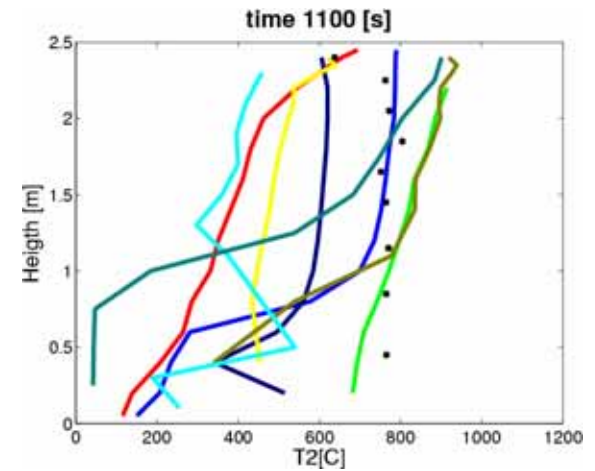
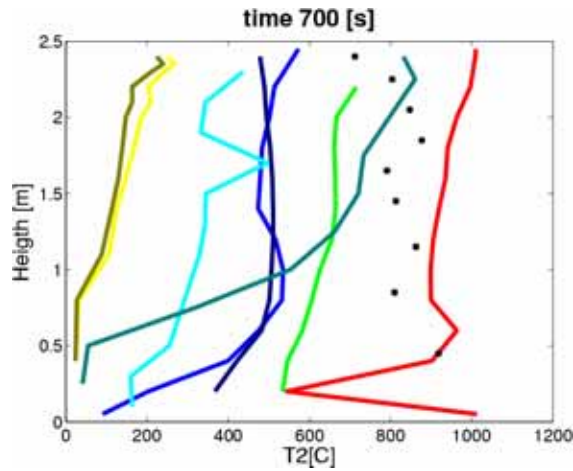
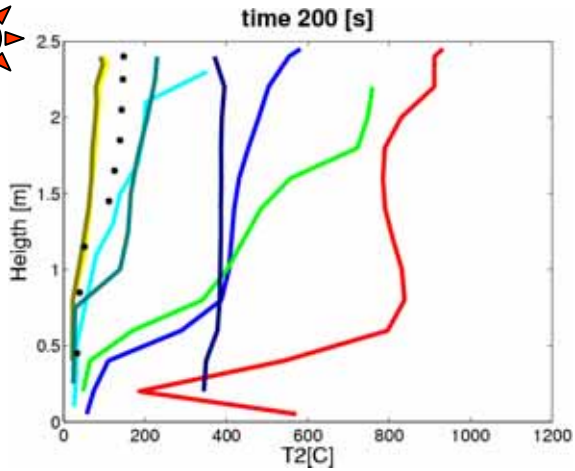
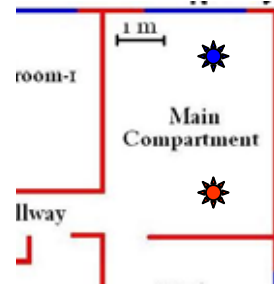

Results: Wall Heat Flux (vs. time)

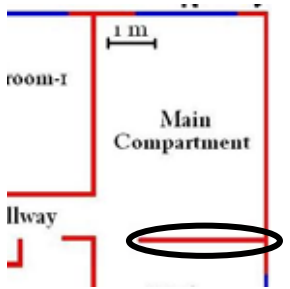
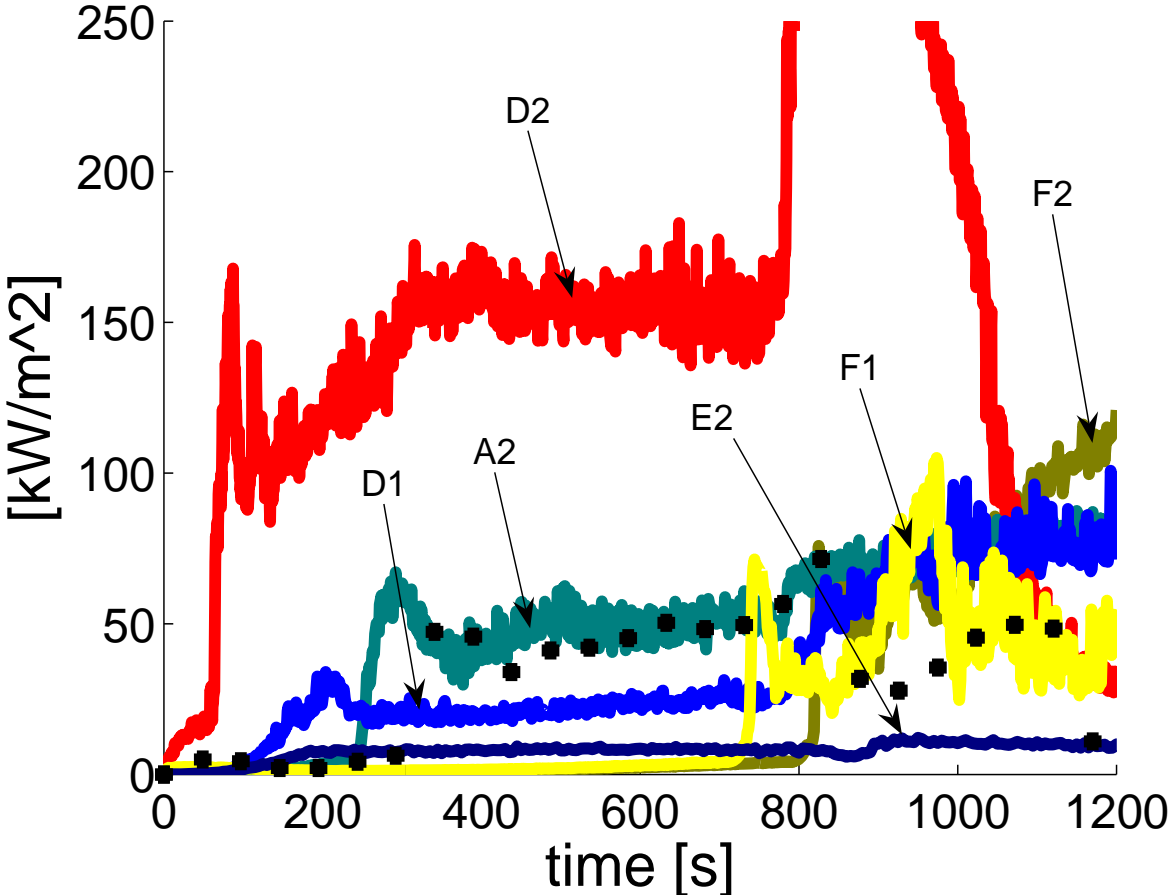

Results: Wall Heat Flux (vs. height)

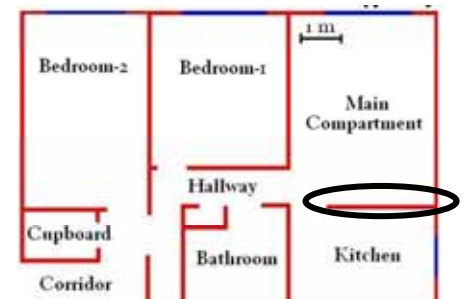
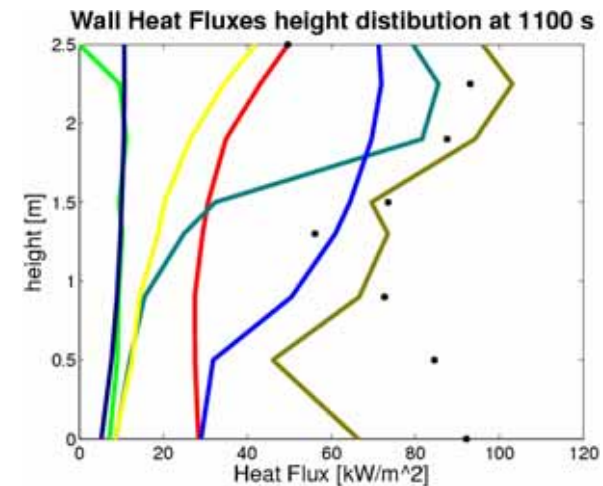
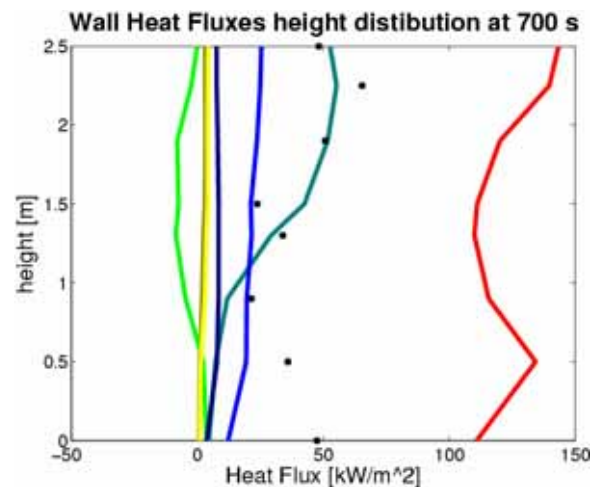
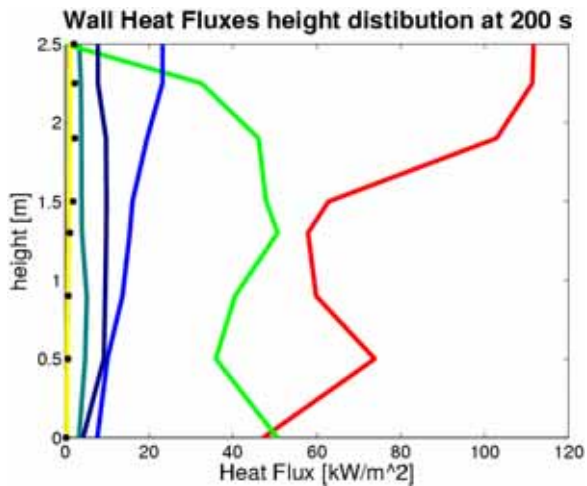

Results: Wall Temperature (vs. time)

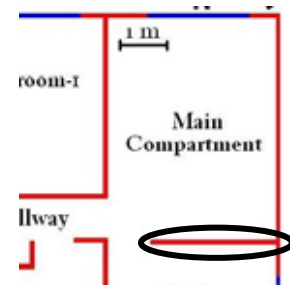
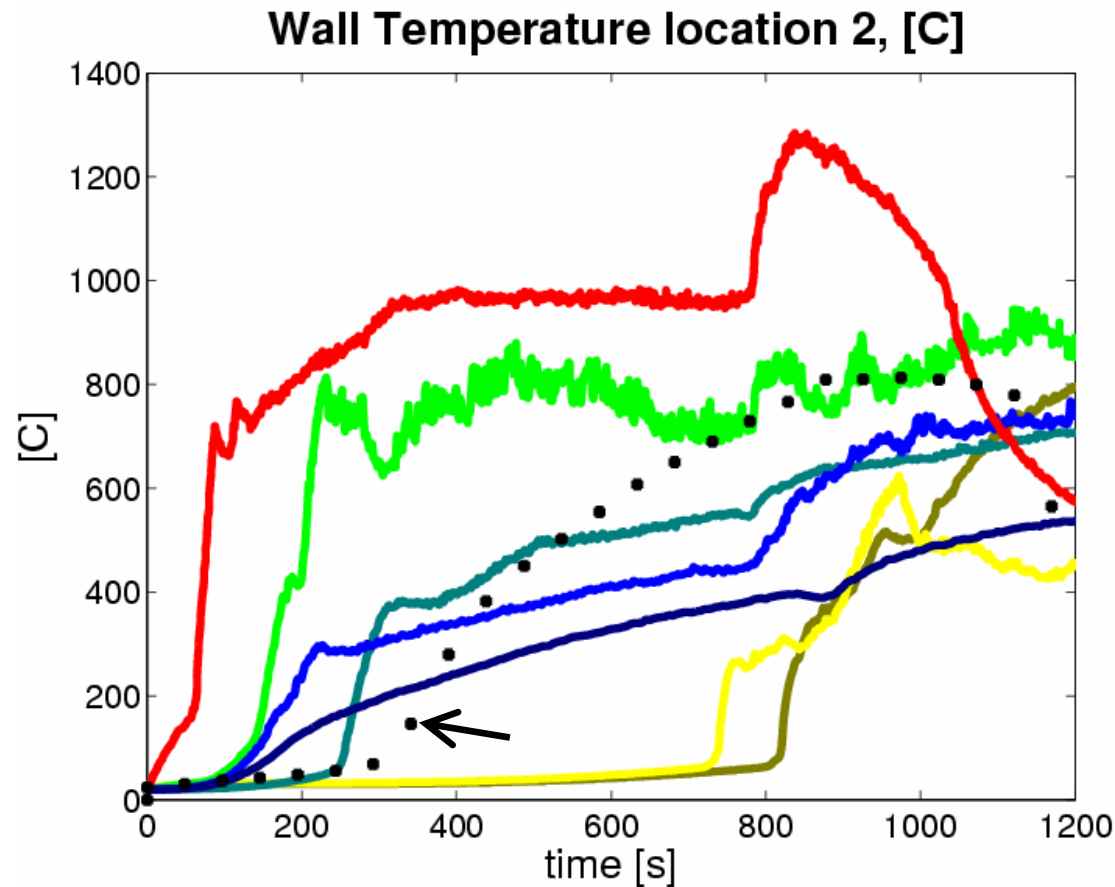

Results: Wall Temperature (vs. height)

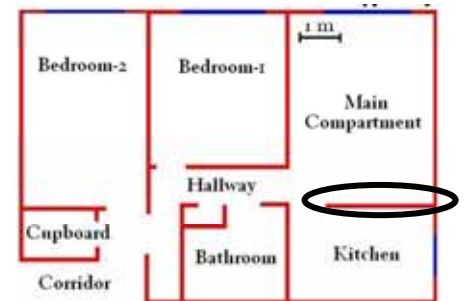
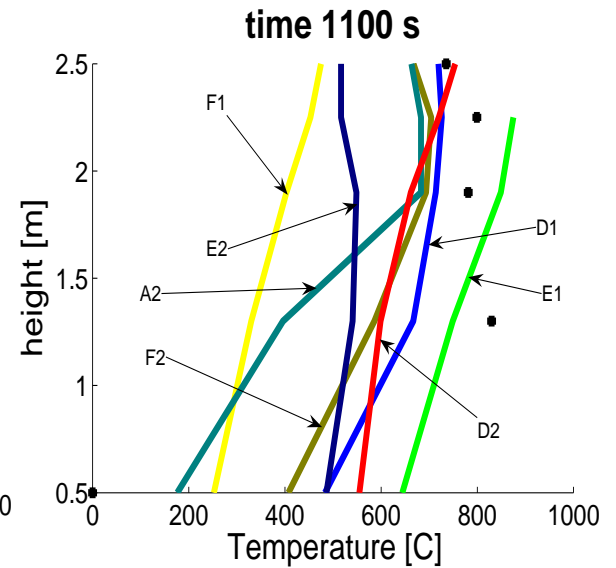
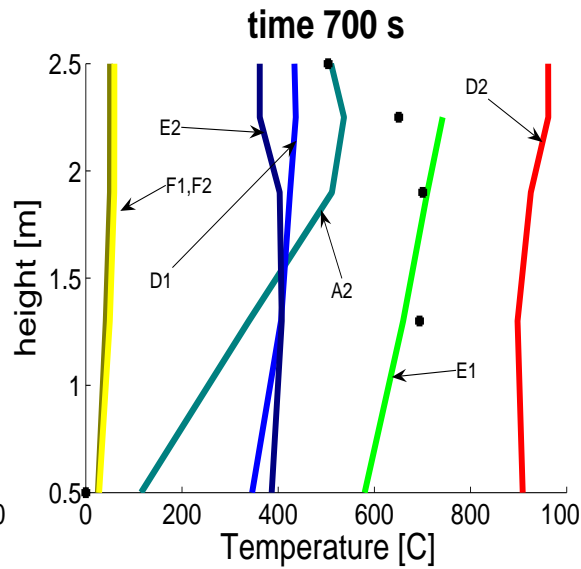
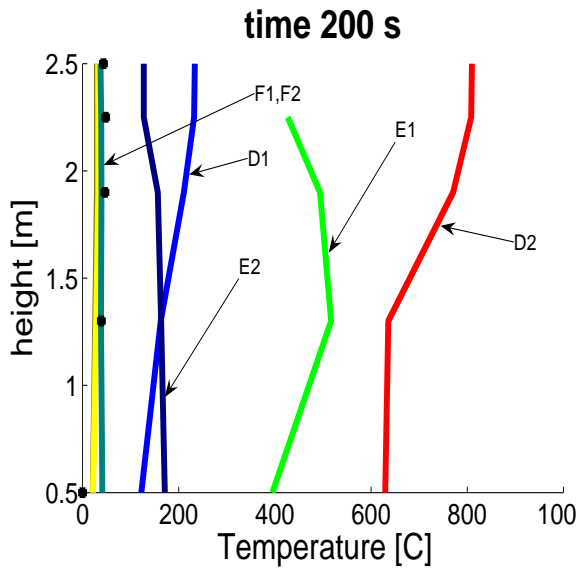

Repeatability: Tests One and Two

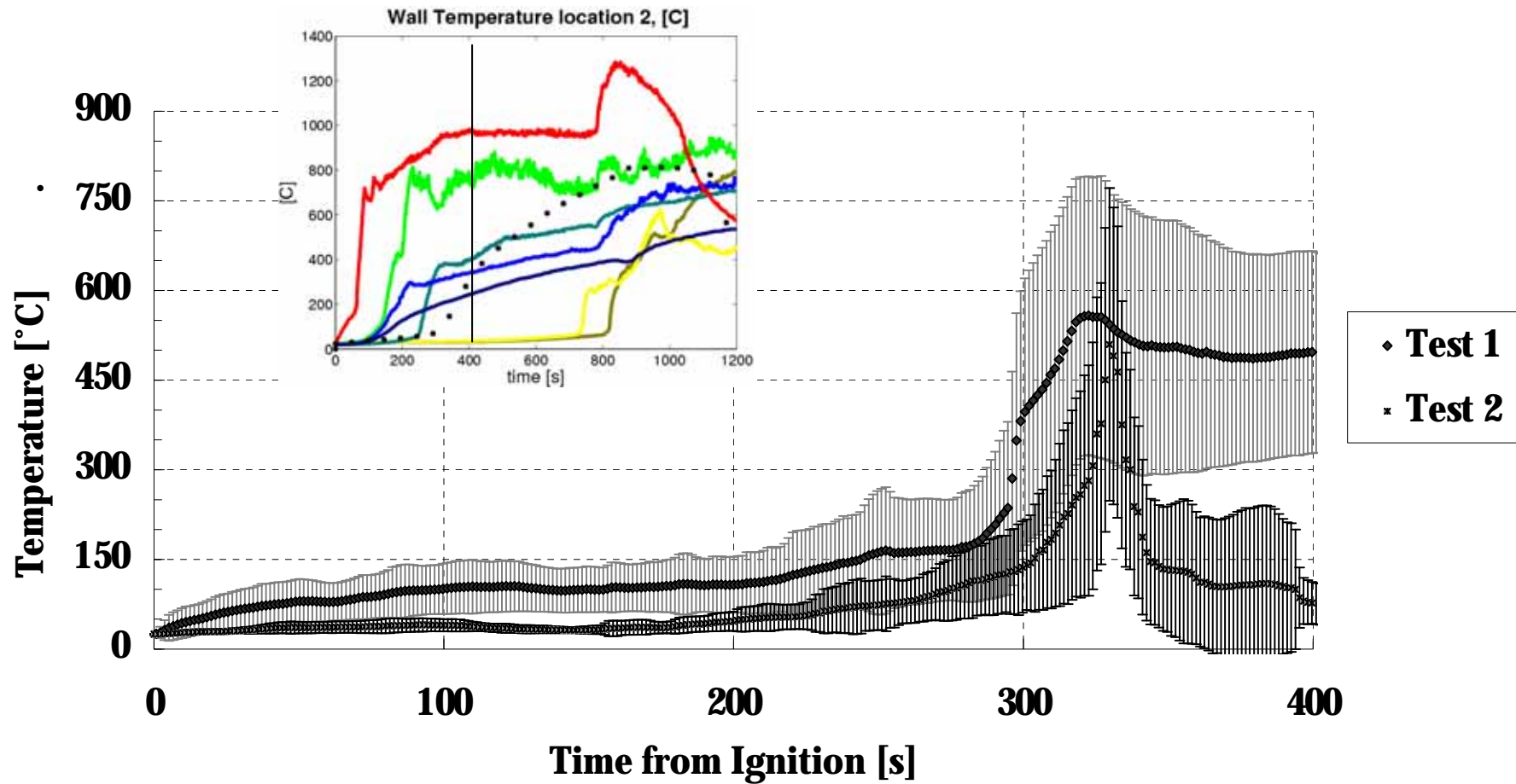

Conclusions

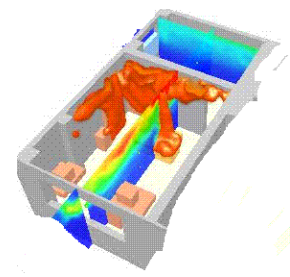

assessment of the state-of-the-art for a real scenario

- Large scatter around the measurements (much larger than experimental error)
- Lowest scatter away from the fire and during post-flashover
- Results are very sensitive to *a priori* assumptions of fire growth and ventilation
- It could be said that out of 10 simulation, 1 did well, 3 did decent, 6 did poorly (but not our objective)

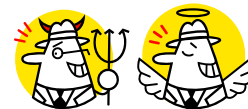

Lessons and Recommendations

- Inherent difficulties of predicting dynamics
- Lessons for Fire modelling (applies to **any** fire model)
- Results give a sense of how far we can go in details...

- Main source of scatter is the excess in degrees of freedom (specially material properties)

- To encourage the debate and exchange of views on the topic
- Great opportunity for further work and novel contributions



ARUP



Summary Results

	growth		post-flashover	
	over	under	over	under
Flashover	30%	60%	-	-
HRR	-	-	10%	60%
Smoke Layer Temperature	40%	20%	50%	10%
Smoke Layer Height	70%	0%	35%	40%
Gas Temperature	0%	50%	45%	5%
Wall Temperature	40%	10%	55%	5%
Wall Heat Flux	0%	50%	45%	5%



A Priori Modelling of Fire Test One

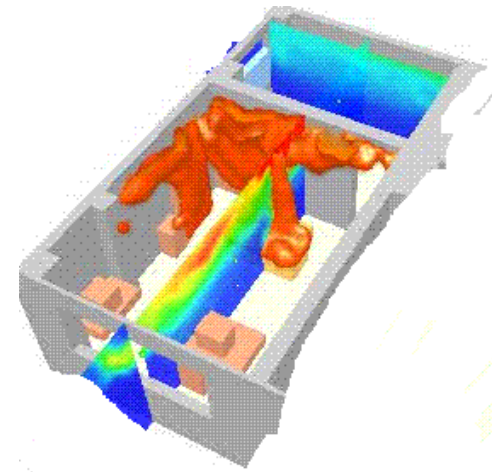

One Day Symposium on
**The Dalmarnock Fire Tests:
Experiments & Modelling**

Wednesday 14th November 2007
Royal Museum, Edinburgh
www.see.ed.ac.uk/FIRESEAT





Gone for Good 2006
Acrylic on oil on panel / 122 X 160cm / © the artist /
courtesy of Magnus Karlsson, Stockholm; Stephen Friedman
Gallery, London; and David Zwirner, New York



ARUP



